

PROPOSED UNDERPASSES AND BRIDGES

A number of underpasses and new bridges are required for the proposed dual carriageway works. Whilst details are still being developed and are subject to change the current options being considered for these structures are shown below.

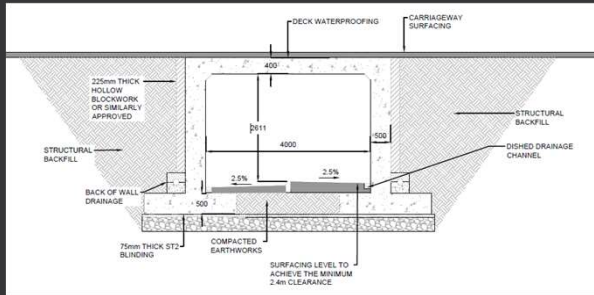

Typical Cross Section Through Proposed Haxby Roundabout Underpasses

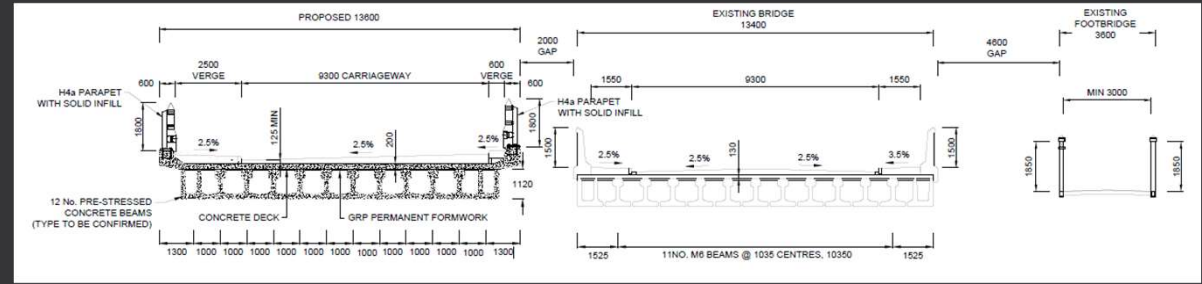

Typical Cross Section Through Existing and Proposed Bridges over York – Scarborough Railway Line

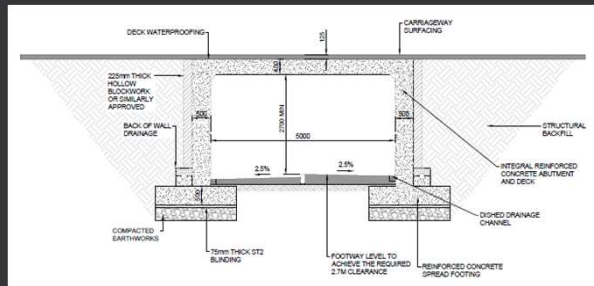

Typical Cross Section Through Proposed Underpass at Strensall Road Roundabout

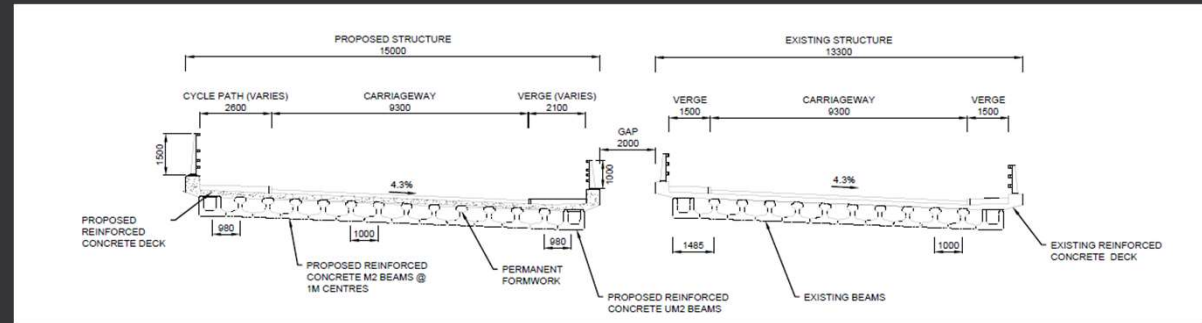

Typical Cross Section Through Existing and Proposed River Foss Bridges

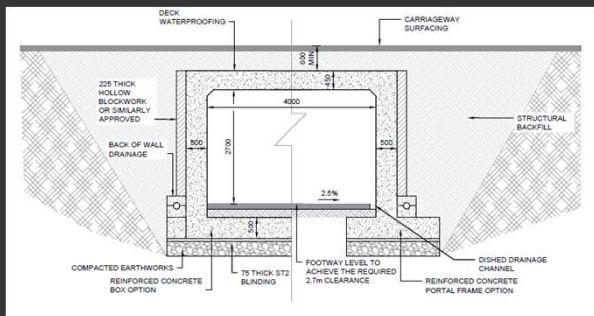

Typical Cross Section Through Proposed Clifton Moor Underpass



View of Existing Bridges Crossing the York – Scarborough Railway



View of the Existing Road Bridge Crossing the River Foss



View Through Existing (Western) Haxby Roundabout Underpass